

# classic<sup>®</sup> KWN1259

## Installation Instructions

### Tools and Materials

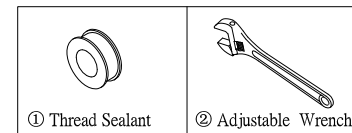

### Names of Component

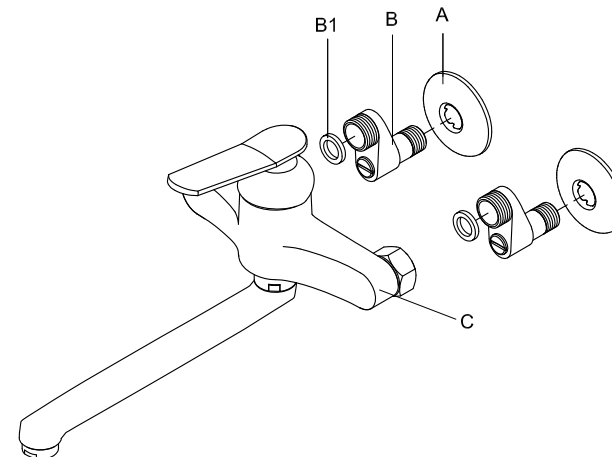

NO	NAME
A	Flange Cover
B	Check Valve with Stopping Water Rivet
B1	Packing
C	Faucet (Mixer body)

## Installation process

(1)

Install B into A, then apply pipe sealant to threads on B ( photo I ) Wrenched B + A to water supply hose ( photo II )

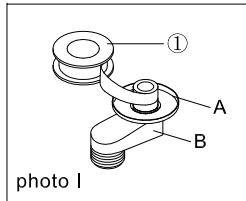
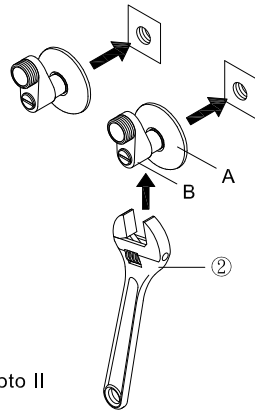

photo I



(2)

Install B1 into hot and cold inlets (C1), which located in the rear of faucet body C. Then, wrench C1 to B and make sure the faucet body C is stabilized on B (photo I.)

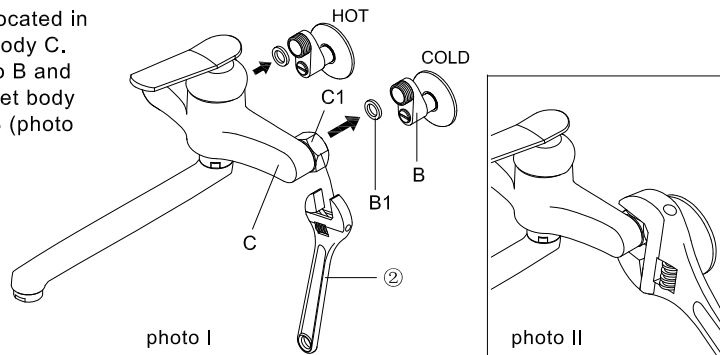

photo I

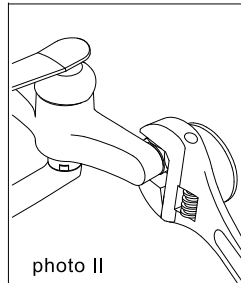
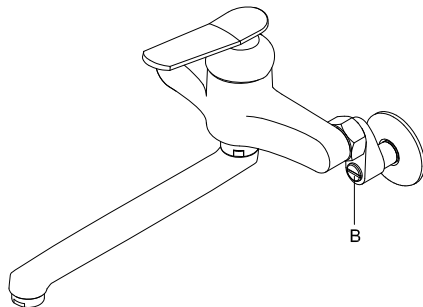

photo II

(3) Installation finished.

Release the stopping water rivet of check valve B.



## How to Use

(1) Installation finished.

Push handle to left to dispense cold water; on the contrary to dispense hot water.

(2) Diverter of hand shower and tub spout

Lift up the diverter then roll it slightly to clockwise direction to "hand shower model."

Roll it slight anti-clockwise direction to press down the diverter to " tub spout model."

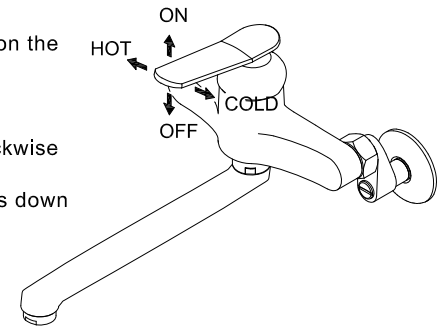

## Maintain and Cleaning

(1) Day to day basis: Drying our faucets with a soft cloth immediately after using them.

(2) Spraying our faucets with mild cleaner ( PH value = 7), followed by cleaning them with water then drying them with a dried- soft cloth.

(3) Aerator which be installed at spout of faucet should be taken off and cleaned in case mineral deposits blocked the filtered net. It will cause the volume of water given decreased .

